



## 2011 Rates & Information



### RESORT AMENITIES

#### Resort Services & Activities

**No Resort Fees.** Keiki (Children) Eat Free Program. Our rates include: Mid-morning refreshments at the Beach Cabana with Hawaiian cultural presentations. Adult Putting Party on our 18-hole putting green with 50¢ cocktails each Monday. Mai Tai Party hosted each Wednesday by the Staff. Weekly flower lei making, horticultural tour, and hula lesson. Weekly Keiki Hula Show (fee). Weekly Slack Key Concert (fee). Self-serve coffee and tea in the Lobby each morning and afternoon. Complimentary use of beach towels, beach chairs, beach mats, shuffleboard, picnic coolers, bocce ball, croquet and golf putters. Four swimming pools. Large heated adult whirlpool. Barbecue areas. Complimentary high-speed internet access in your room. Internet Kiosk in the Lobby (fee). Internet wireless hotspot in lobby.



#### Keiki (Children's) Activities

Spring Break/Easter, mid-June to mid-August, Thanksgiving, and Christmas for children ages 6-10. Complimentary to in-house guests. A 24-hour advance registration is required.

#### Sea House Restaurant

Breakfast, lunch, pupus, dinner and cocktails are served. Hawaiian entertainment nightly. Private dining available at Lani Point for 2-12 people. Wedding reception and other banquet services for up to 24 people in the Sea House, 25-90 people on the Lani Terrace, and 60-250 people at the Aloha Pavilion. Contact catering@napilikai.com



### MILEAGE CHART

From Napili Kai Beach Resort:	
WEST MAUI AIRPORT	3 MI
KAANAPALI	5 MI
LAHAINA	9 MI
MAALAEA	27 MI
WAILUKU	30 MI
KIHEI	33 MI
KAHULUI AIRPORT	36 MI
HALEAKALA	63 MI
HANA	80 MI



### FOR RESERVATIONS

Contact your Travel Agent, phone our Reservations Department on Maui, or visit our website to book online or view our webcam:  
[www.napilikai.com](http://www.napilikai.com)

TOLL FREE USA and CANADA

**800-367-5030**

6:30am-4:30pm Hawaii Time,  
Monday-Friday

Reservations Fax: 808-669-0086

Email: stay@napilikai.com

5900 Lower Honoapiilani Road  
Lahaina, HI 96761

All other calls: 808-669-6271

All other faxes: 808-669-5740

GPS Guide

Longitude 156.66544

Latitude 20.99713

#### Makai Hale

Complimentary sports and beach equipment. Snacks, espresso, cappuccino, lattes, milkshakes and smoothies. Guest room charge only.

#### Fitness Center

Air-conditioned, fitness center with a variety of workout equipment.

#### Meeting Facilities

Meeting, seminar and retreat facilities are available in the Pili Aloha room for up to 34 participants and at the outdoor Aloha Pavilion for 60-250 participants. Contact sales@napilikai.com.

#### Wedding Ceremony

Wedding ceremony locations are available on property for parties of 2-250 people. Contact yourwedding@napilikai.com for details.

#### Activities and Concierge Desk

Assists in booking Maui's best sightseeing tours, fishing charters, dinner cruises, luaus, helicopter rides, zipline, Eco hikes and more! Call toll free 1-877-669-0572 for advance bookings.

#### Makai Massage & Bodywork

Pamper yourself with a massage, facial, or body treatment at our boutique spa. Moonlight massage also available. Call 808-669-2000 for appointments.

#### Breezeway Boutique

Delightful boutique on the premises. Lovely Hawaiian gifts, clothing, and estate jewelry. Call 808-669-6703 for hours.

#### Tennis

Courts adjacent to resort with pro on duty at Kapalua (fee).

#### Golf

Two championship Kapalua Golf Courses are located adjacent to Napili Kai Beach Resort. Kaanapali championship courses are 5 miles south.

### INFORMATION

#### General

A 10% discount on published rates applies to accommodations occupied for 30 days or longer, packages excluded. All rates subject to change without notice. Check-in time: 3:00pm. Check-out time: 12 Noon.

Specific building, location, floor, room number, or A/C are not guaranteed. A premium of \$350 for a hotel room or studio, or \$450 for a suite will guarantee specific building, location, A/C, floor, or room number of each unit. This premium is payable in advance, is non-commissionable, non-refundable, non-transferable, and will not be applied as a deposit against the daily room rate. Payment is due upon booking. Without the premium, the specific building, location, floor, A/C, or room number will be a preference only, not guaranteed and based on availability at check-in.

Some units are privately owned in Puna Point, Puna 2, Lani 1, and Lani 2, and



owners reserve the right to take their unit out of the rental pool for any given arrival date prior to 60 days of their departure date.

Premium payments for privately owned units accepted 60 days prior to departure date, based on availability.

#### Deposit, Revision, and Cancel Policy

A two-night deposit is required upon booking. A 14-day notice prior to arrival date is required for revisions and cancellations. Less than 14 days notice will be subject to forfeiture of two nights' deposit. Reservations for 4 weeks and longer require 7 nights' deposit and a 30-day cancellation/revision notice. Notice of less than 30 days will be subject to 7 night forfeiture of deposit. All reservations without deposit are subject to cancellation without notice. Family and group deposit policies for 4 or more units will differ.

CHRISTMAS POLICY: A minimum stay of 7 nights is required for any stay that includes 12/18/10 through 1/4/11. Christmas 2011 rates are to be determined. (Shorter stays may be requested after September 1, space available.) A 7-night deposit is due upon booking. All payments are non-refundable after September 1.

#### Methods of Payment

Travellers' cheques, personal checks with identification, cash, Visa, MasterCard, American Express and Discover accepted.

#### Airport Information & Transfer

Kahului Airport (OGG) is 36 miles from Napili Kai Beach Resort. Taxis are also available each way for approximately \$100. Shuttles are approximately \$75. Kapalua-West Maui Airport (JHM) is 15 minutes from Napili Kai Beach Resort and taxis are available, approximate cost is \$12, one way. Courtesy phones are at baggage claim for shuttle service.

#### Policies

All policies and rates are subject to change without notice.



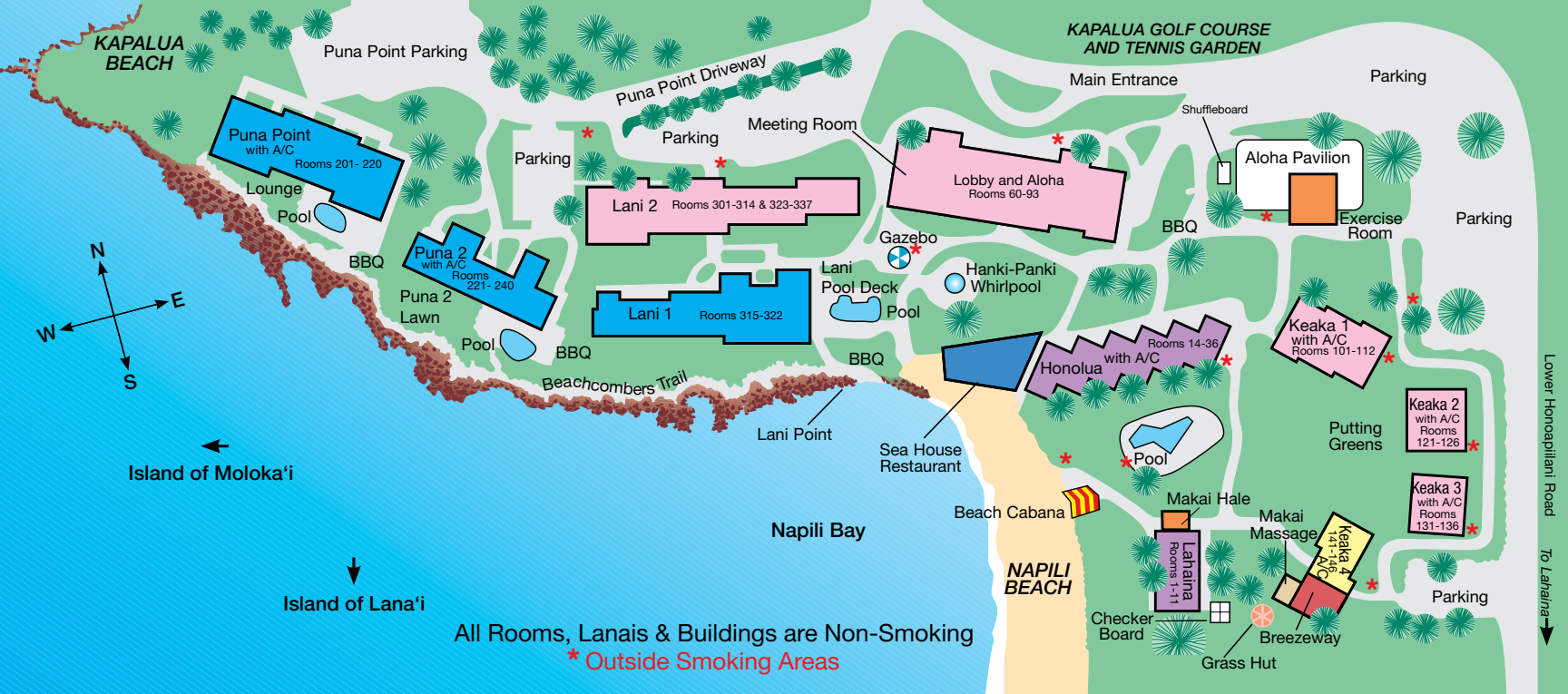

All Rooms, Lanais & Buildings are Non-Smoking  
 \* Outside Smoking Areas

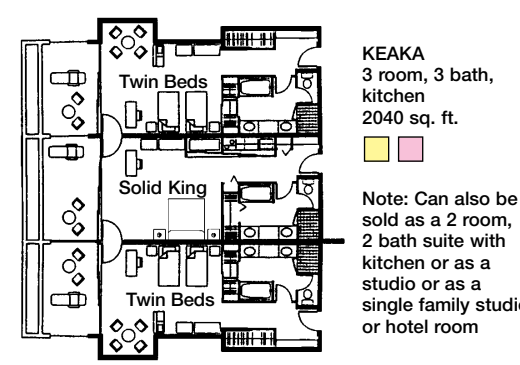
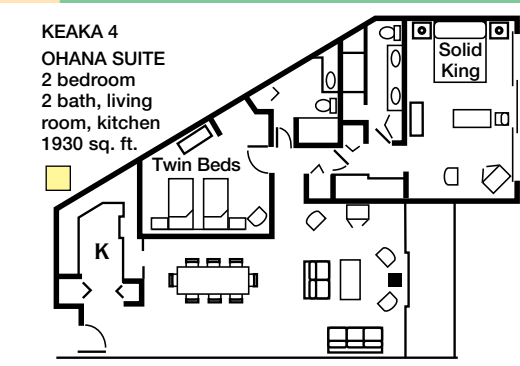
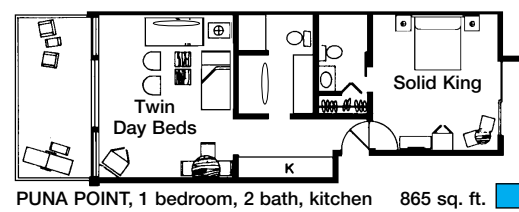
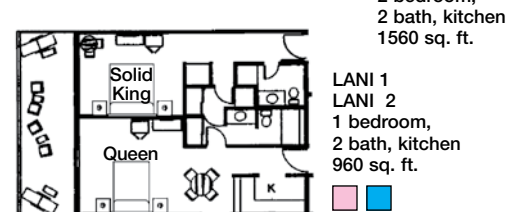
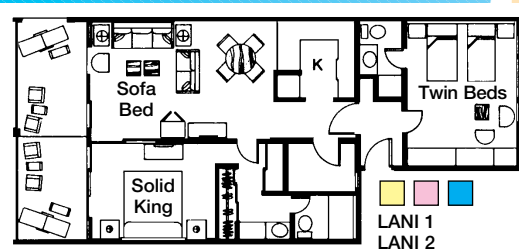
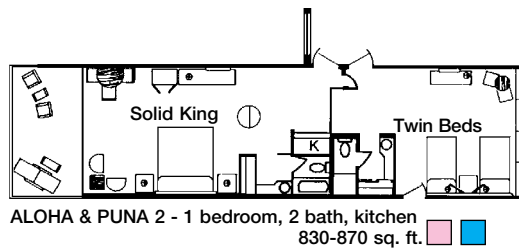
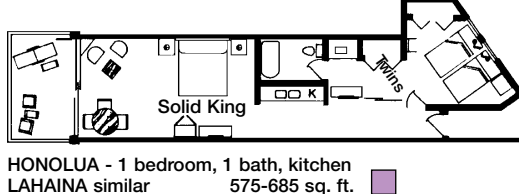
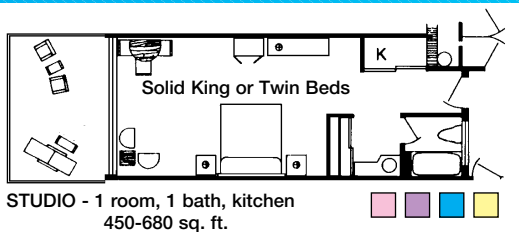

Note: Floor plans not to scale. Square footage includes lanai and is approximate.

**ROOM AMENITIES**

- Large Private Lanais with Ocean Views
- Deluxe Kitchenettes
- Color TVs
- 5 Cable Music Channels
- DVD/CD Player
- Telephone and Voicemail
- Accommodations are Air Conditioned or have Ceiling Fans
- Washer and Dryer facilities with Complimentary Detergent
- Iron/Ironing Board
- Complimentary Rollaway Beds and Cribs
- Hair Dryers
- Free Parking
- In-room Safe
- Coffee and Coffee Maker
- ADA Accessible Rooms
- Daily Maid Service

- Internet Wireless Hot Spot in Lobby
- Internet Kiosk in Lobby
- Complimentary High-speed Internet Access in Rooms
- Wireless Internet in Puna 2
- AM/FM Clock Radio

**Smoking**

All buildings, rooms and lanais are non-smoking. Smoking areas are designated on the property map. Cigar smoking is not permitted anywhere on the property.



**ACCOMMODATION DESCRIPTIONS**

**Hotel Room**

One large room with bath and private lanai. Includes small refrigerator and coffee maker. Accommodates 1-3 persons. Solid king or two twin beds and queen sofa bed. Crib available upon request.

**Studio**

One large room with fully equipped kitchenette, bath, and private lanai. Accommodates 1-3 persons. Solid king or two twin beds. Rollaway or crib (upon request) for 3rd person.

**Family Studio (Keaka Only)**

One large room with fully equipped kitchenette, one large bath and large private lanai. Solid king or two twins with queen sofa bed. Accommodates family of up to four people with children 12 years and younger. Not suitable for two adult couples or families with children older than 12 years. Crib available upon request.

**1-Bedroom**

Sleeping accommodations in both rooms, 1 or 2 baths, fully equipped kitchenette, and private lanai. Accommodates 2-5 persons. Either solid king and two twin beds, or solid king and queen sofa bed. Rollaway or crib (upon request) for 5th person.

**2-Bedroom**

Two bedrooms with sleeping accommodations also in living room, 2 baths, fully equipped kitchenette, and private lanai. Accommodates 4-7 persons. Solid king, two twin beds, and queen sofa bed. Rollaway or crib (upon request) for 7th person. No packages, specials or discounted rates in this room.

**Keaka 2- and 3-Room Suites**

Two or three side-by-side hotel rooms or studios with interior connecting doors and exterior connecting lanais. Three people maximum per hotel room or studio with solid king or two twin beds and in-room sofa bed. Crib available upon request. (Booked as one accommodation.)

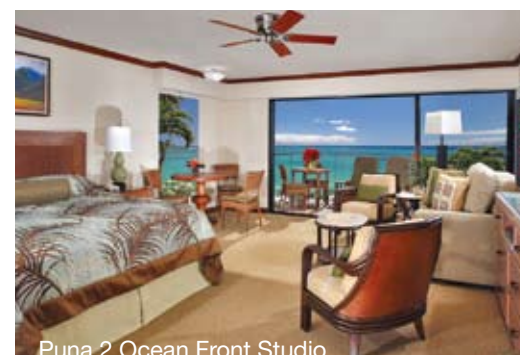

Puna 2 Ocean Front Studio

**RATES**

Room Category	2011 Rates 12/18/10 through 12/16/11
<b>Garden View Keaka 4</b>	
Hotel Room	\$250-\$295
Family Studio	\$320-\$370
2 Room Keaka 4	\$570-\$665
3 Room Keaka 4	\$820-\$960
Garden-View Ohana Suite	\$820-\$960
<b>Ocean View Aloha, Lani 2, Keaka 1, 2, 3</b>	
Hotel Room	\$305-\$355
Family Studio	\$380-\$430
Studio	\$345-\$395
1-Bedroom Suite	\$495-\$595
2-Bedroom Suite	\$715-\$785
2-Room Keaka Suite 1	\$685-\$785
3-Room Keaka Suite 1	\$990-\$1,440
2-Room Keaka Suite 2 & 3	\$760-\$860
3-Room Keaka Suite 2 & 3	\$1,140-\$1,290
<b>Beach Front Lahaina, Honolua</b>	
Studio	\$375-\$425
1-Bedroom Suite	\$530-\$630
<b>Ocean Front Puna Point, Puna 2, Lani 1</b>	
Studio	\$450-\$500
Preferred Studio	\$465-\$515
1-Bedroom Suite Puna Point	\$525-\$625
1-Bedroom Suite Puna 2	\$590-\$690
1-Bedroom Lani 1 Suite	\$590-\$690
2-Bedroom Lani 1 Suite	\$885-\$1,025

All rates subject to 4.166% general excise tax plus 9.25% hotel room tax.

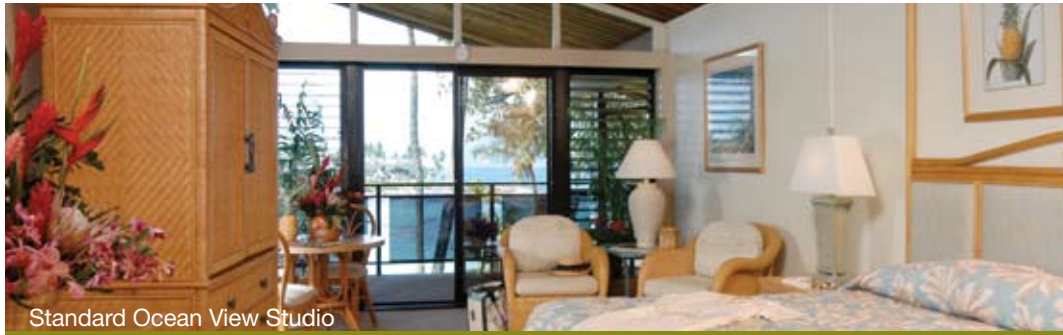

Standard Ocean View Studio

**SPECIALS**

**Value Season Specials**

- 7th Heaven (every 6th and 7th Night Free)
- 5th Night Free (every 5th Night Free)

7th Heaven and 5th Night Free specials are subject to availability and not combinable with each other or any other special. Available in select categories only.

**Kids Eat Free**

Kids 12 years and younger eat free from the Keiki Menu in the Sea House when accompanied by an adult who purchases an adult entree.

**Value Season Dates are: 1/5-1/28/2011; 3/5-4/15/2011; 4/30-6/17/2011 and 8/12-12/16/2011. Please see our website for additional online specials**

**Small Groups, Family Reunions, Wedding Parties, Good Friends, and Celebrations**

Book 4-9 accommodations for 5 nights minimum each and receive: Guarantee of Specific Unit based on availability at the time of booking, Complimentary Photo Session, Napili Kai Special Amenity, and Welcome Flowers in Each Unit. Holiday Season excluded. Discounted rates, packages and specials excluded. Group agreement and final prepayment required 45 days prior to arrival.